

Parts List

Type KS-SE3	Model ALL	Parts List No. PL0028	Revision No. 2
------------------------------	----------------------------	--	---------------------------------

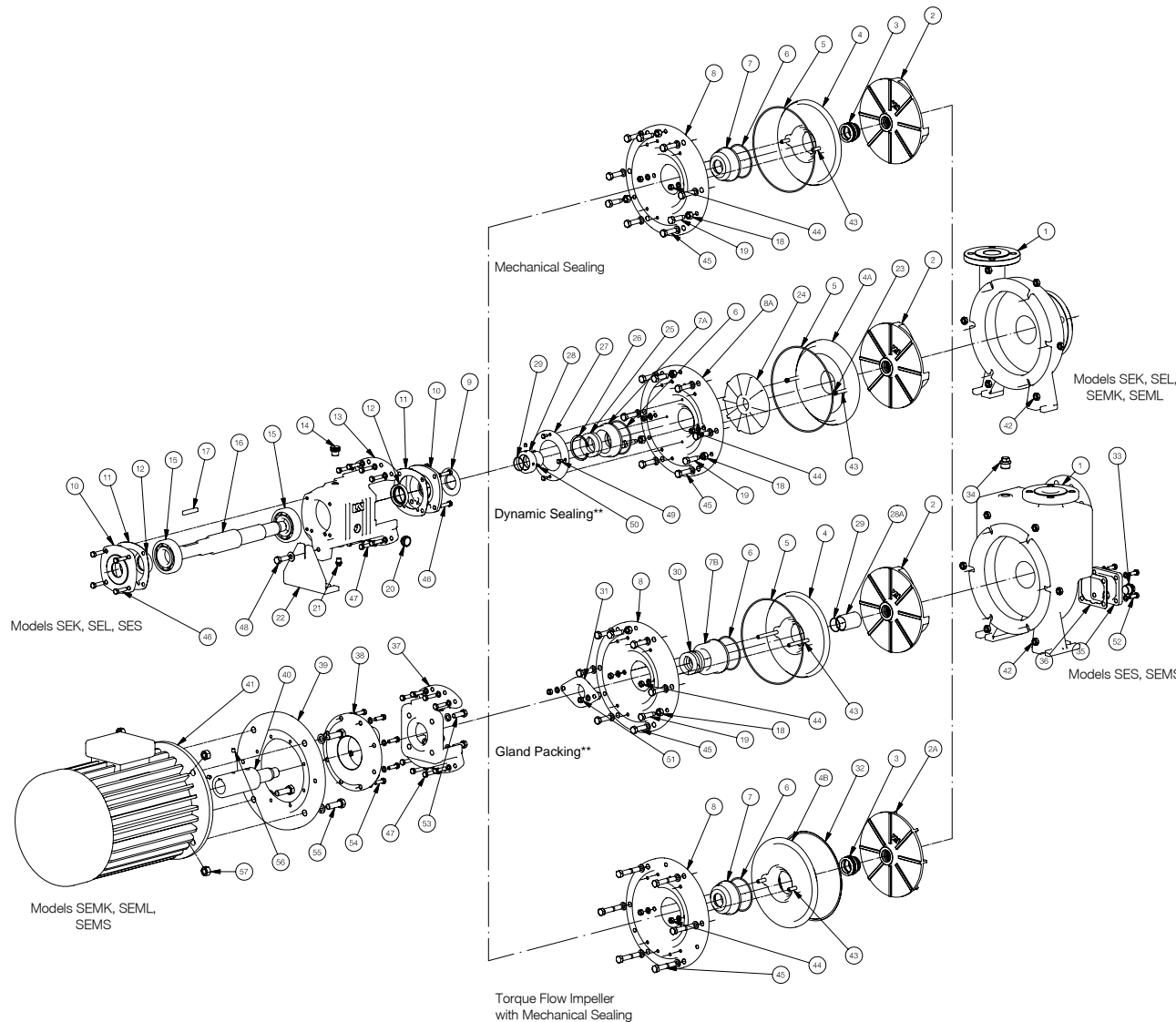

Item No.	Part No.	Description	Standard Material
1	100	Casing	Stainless Steel
2	120.S	Semi-Open Impeller	Stainless Steel
2A	120.F	Torque Flow Impeller	Stainless Steel
3	220.A	Mechanical Seal	Carbon vs. Ceramic
4	210.M/G	Casing Cover for Mechanical Sealing and Gland Packing	Stainless Steel
4A	210.D	Casing Cover for Dynamic Sealing	Stainless Steel
4B	210.FMG	Casing Cover for Torque Flow Impeller with Mechanical Sealing and Gland Packing	Stainless Steel
5	430	Casing Cover *C* Ring	Synthetic Rubber
6	421	Sealing Chamber *C* Ring	Synthetic Rubber
7	211.M	Sealing Chamber for Mechanical Sealing	Stainless Steel
7A	211.D	Sealing Chamber for Dynamic Sealing	Stainless Steel
7B	211.G	Sealing Chamber for Gland Packing	Stainless Steel
8	221.M/G	Adaptor Extension Ring for Mechanical Sealing and Gland Packing	Cast Iron
8A	221.D	Adaptor Extension Ring for Dynamic Sealing	Stainless Steel
9	440	Difflector	Synthetic Rubber
10	320	Bearing Cover	Cast Iron
11	430	Bearing Cover Gasket	Cl Proof Paper
12	321	Oil Seal	Synthetic Rubber
13	301	Bearing Bracket	Cast Iron
14	330	Oil Cover	Aluminum Alloy
15	310	Bearing	Steel
16	130	Shaft	Stainless Steel
17	136	Shaft End Key	Stainless Steel
18	454	Jam Nut	Steel
19	451	Clearance Adjusting Screw	Steel
20	331	Oil Gauge	Plastic Threaded
21	400	Bearing Bracket Drain Plug	Galvanize Steel
22	410	Support Foot	Cast Iron
23	402	Casing Cover Stud *C* Ring	Synthetic Rubber
24	121	Expeller	Stainless Steel
25	202	V-Seal	Synthetic Rubber
26	460	Oil Dip	Steel
27	235	Sealing Chamber Holding Bracket	Cast Iron
28	133.D	Shaft Sleeve for Dynamic Sealing	Stainless Steel
28A	133.G	Shaft Sleeve for Gland Packing	Stainless Steel
29	423	Shaft Sleeve *C* Ring	Synthetic Rubber
30	201	Packing	Cotton
31	213	Gland	Stainless Steel
32	431	Casing Cover Gasket	Asbestos Sheet
33	401	Casing Drain Plug	Stainless Steel
34	402	Venting Plug	Stainless Steel
35	217	Casing Drain Cover	Stainless Steel
36	439	Casing Drain Cover Gasket	Synthetic Rubber
37	220	Frame Adaptor	Cast Iron
38	233*	Motor Frame Adaptor	Cast Iron
39	225	Motor Adaptor Extension Ring	Cast Iron
40	132	Motor Extension Shaft	Stainless Steel
41	501	Flange-Mounted Motor	Steel
42	-	Casing Nut	Steel
43	-	Casing Cover Stud	Steel
44	-	Casing Cover Nut	Steel
45	-	Casing Bolt	Steel
46	-	Bearing Cover Bolt	Steel
47	-	Adaptor Extension Ring Bolt	Steel
48	-	Support Foot Bolt	Steel
49	-	Sealing Chamber Holding Bracket Bolt	Steel
50	-	Shaft Sleeve Set Screw	Steel
51	-	Gland Nut	Steel
52	-	Casing Drain Cover Bolt	Steel
53	-	Motor Frame Adaptor Bolt	Steel
54	-	Motor Adaptor Extension Ring Bolt	Steel
55	-	Motor Bolt	Steel
56	-	Motor Extension Shaft Set Screw	Steel
57	-	Motor Nut	Steel

* Only available in models SEMK, SEML and SEMS with motor horsepower 15HP or 20HP
 ** Only available in models SEK, SEL and SES